

IEM-945GSE

ETX 3.0 CPU Module with Intel® Atom™ processor, VGA/LVDS, LAN, SATA, USB and Audio

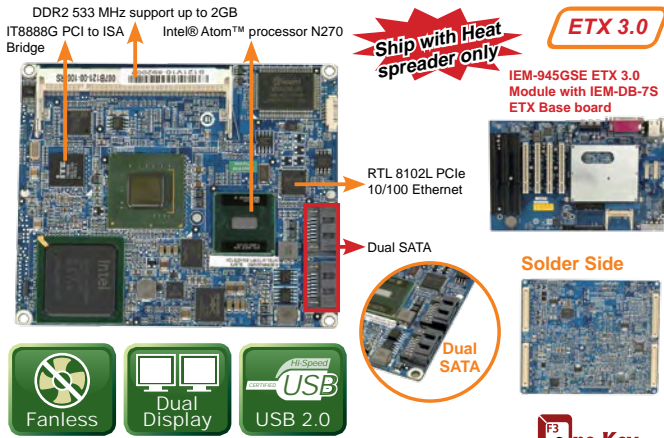

Ship with Heat spreader only
ETX 3.0
 IEM-945GSE ETX 3.0 Module with IEM-DB-7S ETX Base board

Features

1. ETX 3.0 CPU module with on-board two SATA 1.5Gb/s ports
2. Support four PCI, one ISA slot for expansion
3. Support dual display for VGA + LVDS
4. Support four USB 2.0, two SATA, one IDE interface
5. IEI One Key Recovery solution allows you to create rapid OS backup and recovery

Specifications

- ◆ CPU: Intel® Atom™ processor N270 1.6 GHz with 533 MHz FSB
- ◆ System Chipset: Intel® 945GSE + Intel® 82801GBM/ICH7M
- ◆ BIOS: AMI
- ◆ System Memory: One 200-pin 533/400MHz DDR2 SO-DIMM supported (system max. 2GB)
- ◆ Ethernet: One 10/100Mbps Realtek RTL8102E Ethernet chipset (PCIe interface)
- ◆ Super I/O: ITE IT8718
- ◆ I/O Interface: 4 x USB 2.0 (to baseboard), 2 x SATA (on CPU module), 1 x IDE (to baseboard), 1 x LPT (to baseboard), 2 x RS-232 (to baseboard), 1 x PS2 KB/MS (to baseboard)
- ◆ Expansions: 4 x PCI, 32-bit 33MHz PCI bus to baseboard, ISA supported by ITE IT8888G
- ◆ Display Interface: VGA/TV-Out integrated in Intel® 945GSE (to baseboard), 18-bit dual-channel LVDS signal (to baseboard)
- ◆ Watchdog Timer: Software programmable supports 1~255 sec. system reset
- ◆ Power Supply: AT/ATX supported
- ◆ Power Consumption: 5V@2.9A (Intel® Atom™ processor N270 with 1GB DDR2)
- ◆ Operating Temperature: 0°C ~ 60°C (IEM-945GSE-N270-R10), -40°C ~ 85°C (IEM-945GSE-N270W2-R10), -20°C ~ 70°C (IEM-945GSE-N270W-R10)
- ◆ Operating Humidity: 5% ~ 95%, non-condensing
- ◆ Dimensions: 95 mm x 114 mm
- ◆ Weight: GW 600g/NW 250g

Dimensions (mm)

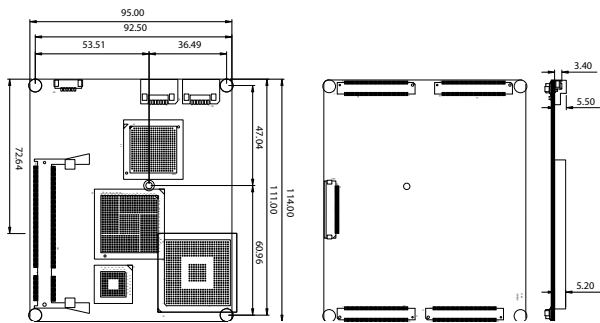

Packing List

1 x IEM-945GSE single board computer	1 x One Key Recovery CD
1 x Heatspreader	1 x Utility CD 1 x QIG

Ordering Information

Part No.	Description
IEM-945GSE-N270-R10	ETX 3.0 module with Intel® Atom™ processor N270 1.6G, VGA/LVDS, LAN, USB, SATA and audio
IEM-945GSE-N270W2-R10	ETX 3.0 module with Intel® Atom™ processor N270 1.6G, VGA/LVDS, LAN, USB, SATA and audio, -40°C ~ 85°C
IEM-945GSE-N270W-R10	ETX 3.0 module with Intel® Atom™ processor N270 1.6G, VGA/LVDS, LAN, USB, SATA and audio, -20°C ~ 70°C
IEM-DB-7S-RS-R30	ATX size 7 slots ETX baseboard

IEM-LX-R11

AMD Geode™ LX 800 Highly Integrated ETX Module

ETX CPU Module with on-board AMD Geode™ LX 800, USB 2.0, LAN & Audio

ETX 2.8

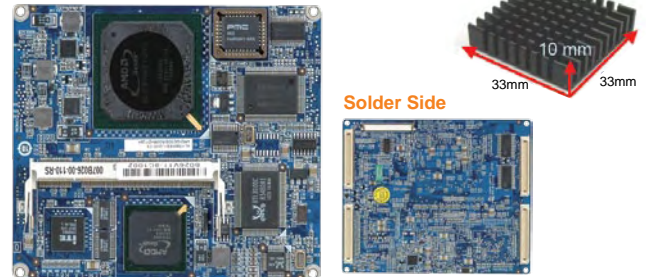

Specifications

- ◆ CPU: On-board AMD Geode™ LX 800 (500MHz) processor
- ◆ System Chipset: AMD Geode™ LX 800 + AMD CS5536
- ◆ BIOS: Award BIOS
- ◆ System Memory: One 200-pin 400/333 MHz DDR SDRAM SO-DIMM Supported (system max. 1GB)
- ◆ Ethernet: 10/100Mbps RTL8100C Ethernet chipset
- ◆ I/O Interface: 4 x USB 2.0, 1 x IDE, 1 x PS/2 KB/MS, 1 x LPT/FDD, 2 x RS-232
- ◆ Expansions: 4 x PCI bus master, ISA support by ITE IT8888G
- ◆ Audio: Realtek ALIC203 AC'97 codec
- ◆ SSD: CF Type II
- ◆ Super I/O: Winbond W83627EHG
- ◆ Display Interface: VGA integrated in AMD Geode™ LX 800 24-bit TTL (optional), 18-bit single-channel LVDS
- ◆ Watchdog Timer: Software programmable supports 1-255 sec. system reset
- ◆ Power Supply: AT/ATX support
- ◆ Power Consumption: 5V@0.92A (AMD Geode™ LX 800 CPU with DDR 333MHz 256MB RAM)
- ◆ Operating Temperature: 0°C ~ 60°C (32°F~140°F)
- ◆ Operating Humidity: 5% ~ 95%, non-condensing
- ◆ Dimensions: 95 mm x 114 mm
- ◆ Weight: GW: 650g/NW: 250g

Dimensions (mm)

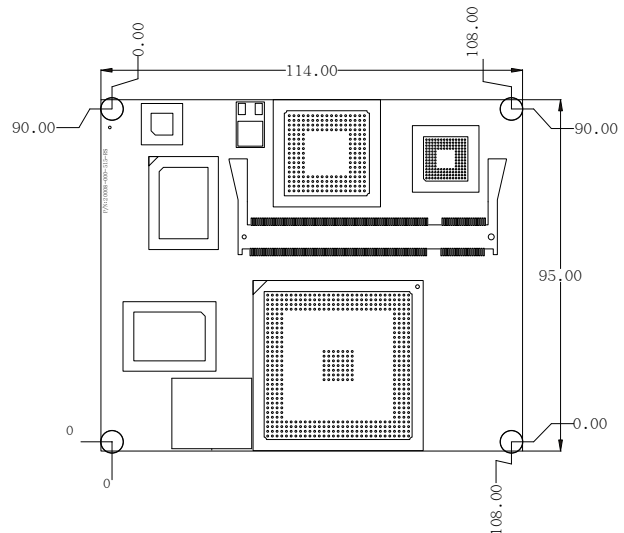

Packing List

1 x IEM-LX single board computer	1 x One Key Recovery CD
1 x Screw kit	1 x Utility CD 1 x QIG

Ordering Information

Part No.	Description
IEM-LX-800-R11	AMD Geode™ LX 800 500MHz processor, VGA/LVDS/TTL, LAN & Audio

1 Industrial Computing Solutions

2 Video Capture Solutions

3 Embedded Computing Solutions

4 Automation Control

5 ORing Network Communication

6 Power Supply/Peripherals

7 Panel Solutions Introduction