

Quick Installation Guide

IES-1000 Series

Industrial Unmanaged Switch

Introduction

IES-1000 Series are industrial unmanaged Ethernet switches. IES-1000 series support dual redundant power inputs, relay output alarm, and rigid IP-30 housing. In addition, the wide operating temperature range from -40°C to 70°C can satisfy most of operating environment.

IES-1000 Series can be used in connecting several Ethernet devices like Ethernet I/O, IP-Camera or other Ethernet switches. In addition, there are two different power inputs at terminal block to avoid interruption caused by power down. When the primary DC power input fails, the backup power input will take over immediately to guarantee a non-stop operation.

Features

- > Dual redundant DC power inputs at terminal block
- > Support 10/100/1000Base-T(X), 100Base-FX and 1000BaseX ports
- > Very wide operating temperature range from -40 to 70°C
- > Rigid IP-30 housing design
- > DIN-Rail and wall mounting enabled

Power Connection Guide

5-port Switches

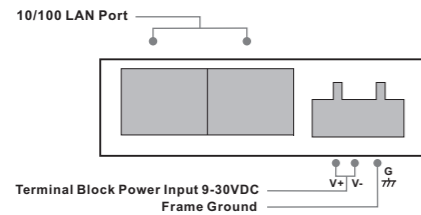

5-port / 6-port / 8-port Switches

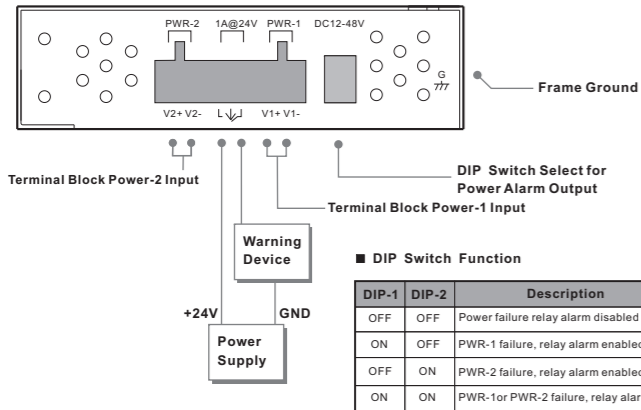

8-port / 10-port Switches

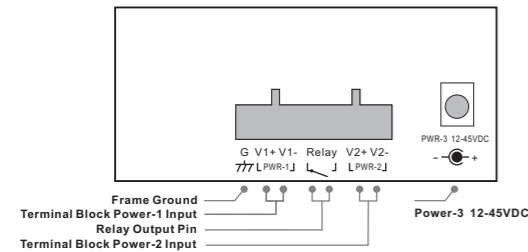

Specifications

8-port / 10-port Unmanaged Switches

ORing Switch Model	IES-1080	IES-1062GT	IES-1062FX-MM	IES-1062FX-SS	IES-1062GF-MM	IES-1062GF-SS	IES-1082GP
Physical Ports							
10/100 Base-T(X) Ports in RJ45 Auto MDI/MDIX	8	6	6	6	6	6	8
10/100/1000 Base-T(X) Ports in RJ45 Auto MDI/MDIX	-	2	-	-	-	-	-
100 Base-FX Multimode Port (2KM,1310nm,SC connector)	-	-	2	-	-	-	-
100 Base-FX Single-mode Port (30KM,1310nm,SC connector)	-	-	-	2	-	-	-
1000Base-SX Multimode Port (550M,850nm,SC connector)	-	-	-	-	2	-	-
1000Base-LX Single-mode Port (10KM,1310nm,SC connector)	-	-	-	-	-	2	-
1000Base-X SFP Port	-	-	-	-	-	-	2
Technology							
Ethernet Standards	IEEE 802.3 for 10Base-T IEEE 802.3u for 100Base-TX and 100Base-FX IEEE 802.3ab for 1000Base-T IEEE 802.3x for Flow control						
MAC Table	8192 MAC addresses						
Processing	Store-and-Forward						
LED Indicators							
Power Indicator	Green: Power LED x3						
Fault Indicator	Amber: Indicate PWR1 or PWR2 failure						
10/100TX RJ45 Port Indicator	Green for port Link/Act. Amber for Duplex/Collision						
Fiber Port Indicator	-	Green for port Link/Act. Amber for Link		Green for port Link/Act.			-
Fault Contact							
Relay	Relay output to carry capacity of 1A at 24 VDC						
Power							
Redundant Input power	Triple DC inputs. 12-48VDC on 7-pin terminal block, 12-45VDC on power jack						
Power consumption(Typ.)	4 Watts	7 Watts	8 Watts	8 Watts	6 Watts	6 Watts	7 Watts
Overload current protection	Present						
Reverse polarity protection	Present on terminal block						
Physical Characteristic							
Enclosure	IP-30						
Dimension (W x D x H)	52(W)x106(D)x144(H) mm (2.05x4.17x5.67 inch.)						
Weight (g)	666 g	677 g	680 g	680 g	685 g	685 g	709 g
Environmental							
Storage Temperature	-40 to 85°C (-40 to 185°F)						
Operating Temperature	-40 to 70°C (-40 to 158°F)						
Operating Humidity	5% to 95% Non-condensing						
Regulatory Approvals							
EMI	FCC Part 15, CISPR (EN55022) class A						
EMS	EN61000-4-2 (ESD), EN61000-4-3 (RS), EN61000-4-4 (EFT), EN61000-4-5 (Surge), EN61000-4-6 (CS), EN61000-4-8, EN61000-4-11						
Shock	IEC60068-2-27						
Free Fall	IEC60068-2-32						
Vibration	IEC60068-2-6						
Safety	EN60950-1						
Warranty	5 years						

5-port / 6-port / 8-port Unmanaged Switches (Slim Type)

ORing Switch Model	IES-1080A	IES-1050A	IES-1041FX-MM	IES-1041FX-SS	IES-1042FX-MM	IES-1042FX-SS
Physical Ports						
10/100 Base-T(X) Ports in RJ45 Auto MDI/MDIX	8	5	4	4	4	4
10/100/1000 Base-T(X) Ports in RJ45 Auto MDI/MDIX	-	-	-	-	-	-
100 Base-FX Multimode Port (2KM,1310nm,SC connector)	-	-	1	-	2	-
100 Base-FX Singlemode Port (30KM,1310nm,SC connector)	-	-	-	1	-	2
1000Base-SX Multimode Port (550M,850nm,SC connector)	-	-	-	-	-	-
1000Base-LX Singlemode Port (10KM,1310nm,SC connector)	-	-	-	-	-	-
1000Base-X SFP Port	-	-	-	-	-	-
Technology						
Ethernet Standards	IEEE 802.3 for 10Base-T IEEE 802.3u for 100Base-TX and 100Base-FX IEEE 802.3x for Flow control					
MAC Table	2048 MAC addresses					
Processing	Store-and-Forward					
LED Indicators						
Power Indicator	Green: Power LED x2					
Fault Indicator	Amber: Indicate PWR1 or PWR2 failure					
10/100TX RJ45 Port Indicator	Green for port Link/Act. Amber for Duplex/Collision					
Fiber Port Indicator	-	Green for port Link/Act.				-
Fault Contact						
Relay	Relay output to carry capacity of 1A at 24 VDC					
Power						
Redundant Input power	Dual DC inputs. 12-48VDC on 6-pin terminal block.					
Power consumption(Typ.)	4 Watts	3.5 Watts	5 Watts	5 Watts	7 Watts	7 Watts
Overload current protection	Present					
Reverse polarity protection	Present					
Physical Characteristic						
Enclosure	IP-30					
Dimension (W x D x H)	26.1(W)x95(D) x 144.3(H) mm (1.30 x 3.74 x 5.68 inch.)					
Weight (g)	391 g	390 g	395 g	395 g	406 g	406 g
Environmental						
Storage Temperature	-40 to 85°C (-40 to 185°F)					
Operating Temperature	-40 to 70°C (-40 to 158°F)					
Operating Humidity	5% to 95% Non-condensing					
Regulatory Approvals						
EMI	FCC Part 15, CISPR (EN55022) class A					
EMS	EN61000-4-2 (ESD), EN61000-4-3 (RS), EN61000-4-4 (EFT), EN61000-4-5 (Surge), EN61000-4-6 (CS), EN61000-4-8, EN61000-4-11					
Shock	IEC60068-2-27					
Free Fall	IEC60068-2-32					
Vibration	IEC60068-2-6					
Safety	EN60950-1					
Warranty	5 years					

5-port Unmanaged Switches

ORing Switch Model	IES-1050
Physical Ports	
10/100 Base-T(X) Ports in RJ45 Auto MDI/MDIX	5
10/100/1000 Base-T(X) Ports in RJ45 Auto MDI/MDIX	-
100 Base-FX Multimode Port (2KM,1310nm,SC connector)	-
100 Base-FX Singlemode Port (30KM,1310nm,SC connector)	-
1000Base-SX Multimode Port (550M,850nm,SC connector)	-
1000Base-LX Singlemode Port (10KM,1310nm,SC connector)	-
1000Base-X SFP Port	-
Technology	
Ethernet Standards	IEEE 802.3 for 10Base-T IEEE 802.3u for 100Base-TX and 100Base-FX IEEE 802.3x for Flow control
MAC Table	2048 MAC addresses
Processing	Store-and-Forward
LED Indicators	
Power / Ready indicator	Green: Power LED x1
Fault Indicator	-
10/100TX RJ45 Port Indicator	Green for port Link/Act. Amber for duplex indicator
Fiber Port Indicator	-
Fault Contact	
Relay	-
Power	
Input power	9~30 VDC voltage power input at 3-pin terminal block
Power consumption(Typ.)	3 Watts
Overload current protection	Present
Reverse polarity protection	Present on terminal block
Physical Characteristic	
Enclosure	IP-30
Dimension (W x D x H)	88(W) x 102(D) x 24(H)mm (3.46 x 4.0 x 0.94 inch.)
Weight (g)	305 g
Environmental	
Storage Temperature	-40 to 85°C (-40 to 185°F)
Operating Temperature	-10 to 60°C (14 to 140°F)
Operating Humidity	5% to 95% Non-condensing
Regulatory Approvals	
EMI	FCC Part 15, CISPR (EN55022) class A
EMS	EN61000-4-2 (ESD), EN61000-4-3 (RS), EN61000-4-4 (EFT), EN61000-4-5 (Surge), EN61000-4-6 (CS), EN61000-4-8, EN61000-4-11
Shock	IEC60068-2-27
Free Fall	IEC60068-2-32
Vibration	IEC60068-2-6
Safety	EN60950-1
Warranty	5 years

Quick Installation Guide

IES-1000 Series

Industrial Unmanaged Switch

Installation

8-port / 10-port Switches

DIN-Rail Install Step

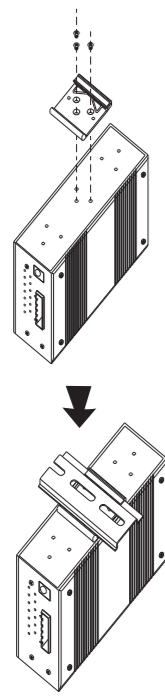

Wall-mounted Install Step

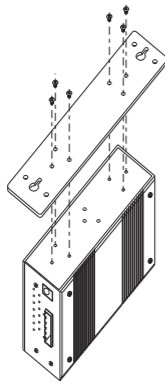

5-port / 6-port / 8-port Switches (Slim type)

DIN-Rail Install Step

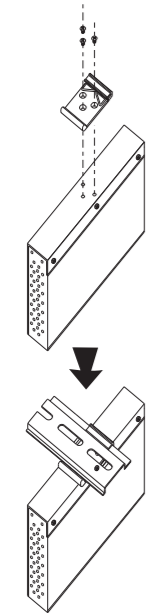

Wall-mounted Install Step

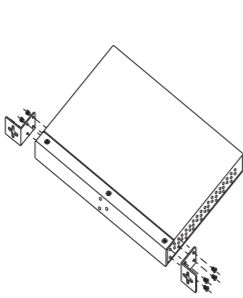

5-port Switches

DIN-Rail Install Step

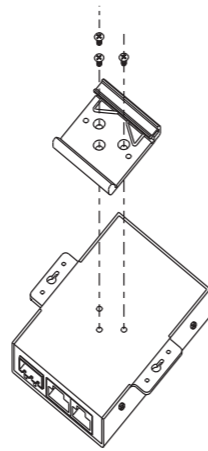

Accessory

① Wall-mounted kit

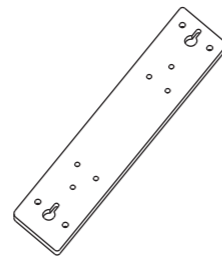

② 45mm DIN-Rail kit

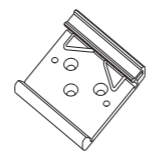

③ Flat Screw (M3 X5)



④ 7-Pin Terminal block

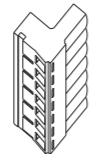

⑤ 3-Pin Terminal block



⑥ 6-Pin Terminal block



⑦ Dust Cover (RJ-45)



⑧ Dust Cover (SFP)



⑨ Round Screw (M3 X3)



⑩ Wall-mounted kit (for Slim Type)



⑪ 25mm DIN-Rail kit

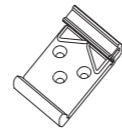

⑫ QIG

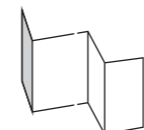

Front Panel

8-port Switches

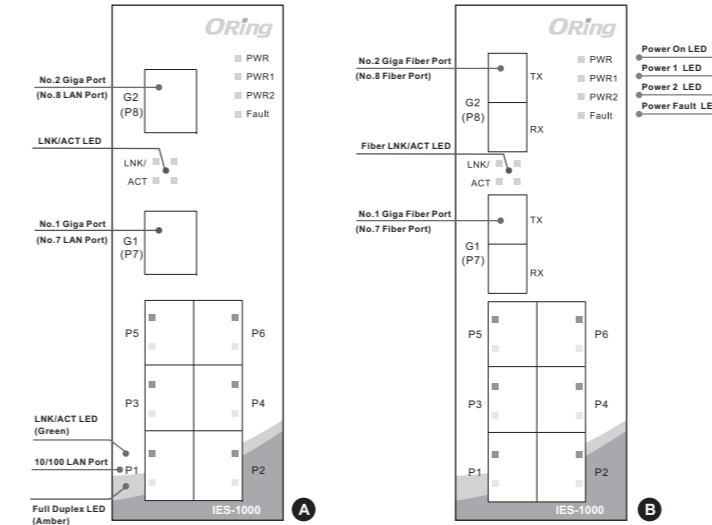

5-port Switches

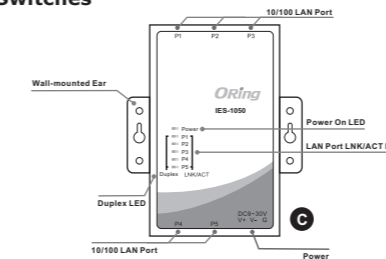

5-port / 6-port / 8-port Switches

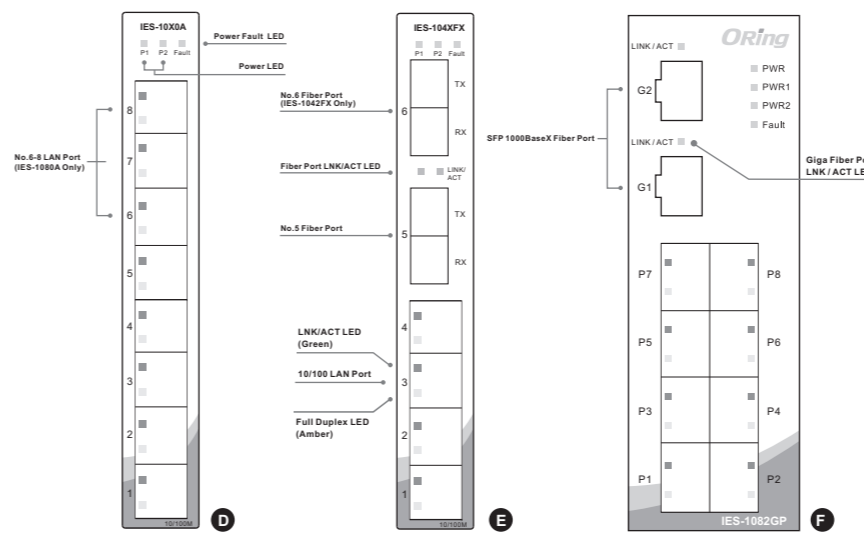

Packing list

IES-1000 Series

Model name	Front Panel	Model Description	Accessory
IES-1080	A	Industrial 8-port unmanaged Ethernet switch with 8x10/100Base-T(X)	⊗X1, ⊗X1, ⊗X6, ⊗X1, ⊗X8, ⊗X1
IES-1062GT	A	Industrial 8-port unmanaged Ethernet switch with 6x10/100Base-T(X) and 2x10/100/1000Base-T(X)	⊗X1, ⊗X1, ⊗X6, ⊗X1, ⊗X8, ⊗X1
IES-1062FX-MM	B	Industrial 8-port unmanaged Ethernet switch with 6x10/100Base-T(X) and 2x100Base-FX, multi-mode	⊗X1, ⊗X1, ⊗X6, ⊗X1, ⊗X8, ⊗X1
IES-1062FX-SS	B	Industrial 8-port unmanaged Ethernet switch with 6x10/100Base-T(X) and 2x1000Base-FX, single-mode	⊗X1, ⊗X1, ⊗X6, ⊗X1, ⊗X8, ⊗X1
IES-1062GF-MM	B	Industrial 8-port unmanaged Ethernet switch with 6x10/100Base-T(X) and 2x1000Base-SX, multi-mode	⊗X1, ⊗X1, ⊗X6, ⊗X1, ⊗X8, ⊗X1
IES-1062GF-SS	B	Industrial 8-port unmanaged Ethernet switch with 6x10/100Base-T(X) and 2x1000Base-LX, single-mode	⊗X1, ⊗X1, ⊗X6, ⊗X1, ⊗X8, ⊗X1
IES-1050	C	Industrial 5-port unmanaged Ethernet switch with 5x10/100Base-T(X)	⊗X1, ⊗X1, ⊗X5, ⊗X1
IES-1082GP	F	Industrial 10-port unmanaged Ethernet switch with 8x10/100Base-T(X) and 2x1000Base-X, SFP socket	⊗X1, ⊗X1, ⊗X6, ⊗X1, ⊗X8, ⊗X2, ⊗X1

IES-1000 Series (Slim Type)

Model name	Front Panel	Model Description	Accessory
IES-1050A	D	Industrial 5-port slim type unmanaged Ethernet switch with 5x10/100Base-T(X)	⊗X1, ⊗X5, ⊗X8, ⊗X2, ⊗X1, ⊗X1
IES-1080A	D	Industrial 8-port slim type unmanaged Ethernet switch with 8x10/100Base-T(X)	⊗X1, ⊗X8, ⊗X8, ⊗X2, ⊗X1, ⊗X1
IES-1041FX-MM	E	Industrial 5-port slim type unmanaged Ethernet switch with 4x10/100Base-T(X) and 1x100Base-FX, multi-mode	⊗X1, ⊗X4, ⊗X8, ⊗X2, ⊗X1, ⊗X1
IES-1041FX-SS	E	Industrial 5-port slim type unmanaged Ethernet switch with 4x10/100Base-T(X) and 1x100Base-FX, single-mode	⊗X1, ⊗X4, ⊗X8, ⊗X2, ⊗X1, ⊗X1
IES-1042FX-MM	E	Industrial 6-port slim type unmanaged Ethernet switch with 4x10/100Base-T(X) and 2x100Base-FX, multi-mode	⊗X1, ⊗X4, ⊗X8, ⊗X2, ⊗X1, ⊗X1
IES-1042FX-SS	E	Industrial 6-port slim type unmanaged Ethernet switch with 4x10/100Base-T(X) and 2x100Base-FX, single-mode	⊗X1, ⊗X4, ⊗X8, ⊗X2, ⊗X1, ⊗X1

ORing Industrial Networking Corp.

Copyright© 2008 ORing
All rights reserved.



TEL: +886-2-2918-3036 Website: www.oring-networking.com
FAX: +886-2-2918-3084 E-mail: support@oring-networking.com