

# Quick Installation Guide

# IES-1000 Series

# Industrial Unmanaged Switch

## Introduction

IES-1000 Series are industrial unmanaged Ethernet switches. IES-1000 series support dual redundant power inputs, relay output alarm, and rigid IP-30 housing. In addition, the wide operating temperature range from -40°C to 70°C can satisfy most of operating environment.

IES-1000 Series can be used in connecting several Ethernet devices like Ethernet I/O, IP-Camera or other Ethernet switches. In addition, there are two different power inputs at terminal block to avoid interruption caused by power down. When the primary DC power input fails, the backup power input will take over immediately to guarantee a non-stop operation.

## Features

- > Dual redundant DC power inputs at terminal block
- > Support 10/100/1000Base-T(X), 100Base-FX and 1000BaseX ports
- > Very wide operating temperature range from -40 to 70°C
- > Rigid IP-30 housing design
- > DIN-Rail and wall mounting enabled

## Power Connection Guide

### 5-port Switches

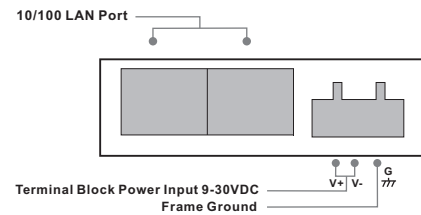

### 5-port / 6-port / 8-port Switches

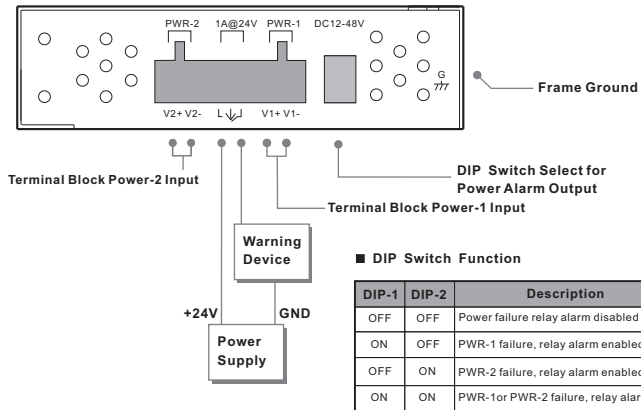

### 8-port / 10-port Switches

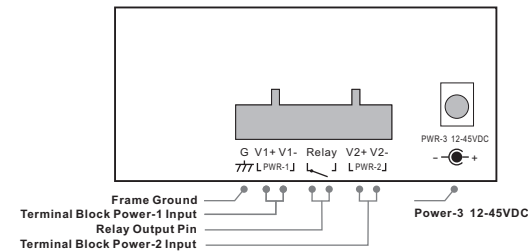

## Specifications

### 8-port / 10-port Unmanaged Switches

ORing Switch Model	IES-1080	IES-1062GT	IES-1062FX-MM	IES-1062FX-SS	IES-1062GF-MM	IES-1062GF-SS	IES-1082GP
<b>Physical Ports</b>							
10/100 Base-T(X) Ports in RJ45 Auto MDI/MDIX	8	6	6	6	6	6	8
10/100/1000 Base-T(X) Ports in RJ45 Auto MDI/MDIX	-	2	-	-	-	-	-
100 Base-FX Multimode Port (2KM,1310nm,SC connector)	-	-	2	-	-	-	-
100 Base-FX Single-mode Port (30KM,1310nm,SC connector)	-	-	-	2	-	-	-
1000Base-SX Multimode Port (550M,850nm,SC connector)	-	-	-	-	2	-	-
1000Base-LX Single-mode Port (10KM,1310nm,SC connector)	-	-	-	-	-	2	-
1000Base-X SFP Port	-	-	-	-	-	-	2
<b>Technology</b>							
Ethernet Standards	IEEE 802.3 for 10Base-T IEEE 802.3u for 100Base-TX and 100Base-FX IEEE 802.3ab for 1000Base-T IEEE 802.3x for Flow control						
MAC Table	8192 MAC addresses						
Processing	Store-and-Forward						
<b>LED Indicators</b>							
Power Indicator	Green: Power LED x3						
Fault Indicator	Amber: Indicate PWR1 or PWR2 failure						
10/100TX RJ45 Port Indicator	Green for port Link/Act. Amber for Duplex/Collision						
Fiber Port Indicator	-	Green for port Link/Act. Amber for Link		Green for port Link/Act.			-
<b>Fault Contact</b>							
Relay	Relay output to carry capacity of 1A at 24 VDC						
<b>Power</b>							
Redundant Input power	Triple DC inputs. 12-48VDC on 7-pin terminal block, 12-45VDC on power jack						
Power consumption(Typ.)	4 Watts	7 Watts	8 Watts	8 Watts	6 Watts	6 Watts	7 Watts
Overload current protection	Present						
Reverse polarity protection	Present on terminal block						
<b>Physical Characteristic</b>							
Enclosure	IP-30						
Dimension (W x D x H)	52(W)x106(D)x144(H) mm (2.05x4.17x5.67 inch.)						
Weight (g)	666 g	677 g	680 g	680 g	685 g	685 g	709 g
<b>Environmental</b>							
Storage Temperature	-40 to 85°C (-40 to 185°F)						
Operating Temperature	-40 to 70°C (-40 to 158°F)						
Operating Humidity	5% to 95% Non-condensing						
<b>Regulatory Approvals</b>							
EMI	FCC Part 15, CISPR (EN55022) class A						
EMS	EN61000-4-2 (ESD), EN61000-4-3 (RS), EN61000-4-4 (EFT), EN61000-4-5 (Surge), EN61000-4-6 (CS), EN61000-4-8, EN61000-4-11						
Shock	IEC60068-2-27						
Free Fall	IEC60068-2-32						
Vibration	IEC60068-2-6						
Safety	EN60950-1						
Warranty	5 years						

### 5-port / 6-port / 8-port Unmanaged Switches (Slim Type)

ORing Switch Model	IES-1080A	IES-1050A	IES-1041FX-MM	IES-1041FX-SS	IES-1042FX-MM	IES-1042FX-SS
<b>Physical Ports</b>						
10/100 Base-T(X) Ports in RJ45 Auto MDI/MDIX	8	5	4	4	4	4
10/100/1000 Base-T(X) Ports in RJ45 Auto MDI/MDIX	-	-	-	-	-	-
100 Base-FX Multimode Port (2KM,1310nm,SC connector)	-	-	1	-	2	-
100 Base-FX Singlemode Port (30KM,1310nm,SC connector)	-	-	-	1	-	2
1000Base-SX Multimode Port (550M,850nm,SC connector)	-	-	-	-	-	-
1000Base-LX Singlemode Port (10KM,1310nm,SC connector)	-	-	-	-	-	-
1000Base-X SFP Port	-	-	-	-	-	-
<b>Technology</b>						
Ethernet Standards	IEEE 802.3 for 10Base-T IEEE 802.3u for 100Base-TX and 100Base-FX IEEE 802.3x for Flow control					
MAC Table	2048 MAC addresses					
Processing	Store-and-Forward					
<b>LED Indicators</b>						
Power Indicator	Green: Power LED x2					
Fault Indicator	Amber: Indicate PWR1 or PWR2 failure					
10/100TX RJ45 Port Indicator	Green for port Link/Act. Amber for Duplex/Collision					
Fiber Port Indicator	-	Green for port Link/Act.				-
<b>Fault Contact</b>						
Relay	Relay output to carry capacity of 1A at 24 VDC					
<b>Power</b>						
Redundant Input power	Dual DC inputs. 12-48VDC on 6-pin terminal block.					
Power consumption(Typ.)	4 Watts	3.5 Watts	5 Watts	5 Watts	7 Watts	7 Watts
Overload current protection	Present					
Reverse polarity protection	Present					
<b>Physical Characteristic</b>						
Enclosure	IP-30					
Dimension (W x D x H)	26.1(W)x95(D) x 144.3(H) mm (1.30 x 3.74 x 5.68 inch.)					
Weight (g)	391 g	390 g	395 g	395 g	406 g	406 g
<b>Environmental</b>						
Storage Temperature	-40 to 85°C (-40 to 185°F)					
Operating Temperature	-40 to 70°C (-40 to 158°F)					
Operating Humidity	5% to 95% Non-condensing					
<b>Regulatory Approvals</b>						
EMI	FCC Part 15, CISPR (EN55022) class A					
EMS	EN61000-4-2 (ESD), EN61000-4-3 (RS), EN61000-4-4 (EFT), EN61000-4-5 (Surge), EN61000-4-6 (CS), EN61000-4-8, EN61000-4-11					
Shock	IEC60068-2-27					
Free Fall	IEC60068-2-32					
Vibration	IEC60068-2-6					
Safety	EN60950-1					
Warranty	5 years					

### 5-port Unmanaged Switches

ORing Switch Model	IES-1050
<b>Physical Ports</b>	
10/100 Base-T(X) Ports in RJ45 Auto MDI/MDIX	5
10/100/1000 Base-T(X) Ports in RJ45 Auto MDI/MDIX	-
100 Base-FX Multimode Port (2KM,1310nm,SC connector)	-
100 Base-FX Singlemode Port (30KM,1310nm,SC connector)	-
1000Base-SX Multimode Port (550M,850nm,SC connector)	-
1000Base-LX Singlemode Port (10KM,1310nm,SC connector)	-
1000Base-X SFP Port	-
<b>Technology</b>	
Ethernet Standards	IEEE 802.3 for 10Base-T IEEE 802.3u for 100Base-TX and 100Base-FX IEEE 802.3x for Flow control
MAC Table	2048 MAC addresses
Processing	Store-and-Forward
<b>LED Indicators</b>	
Power / Ready indicator	Green: Power LED x1
Fault Indicator	-
10/100TX RJ45 Port Indicator	Green for port Link/Act. Amber for duplex indicator
Fiber Port Indicator	-
<b>Fault Contact</b>	
Relay	-
<b>Power</b>	
Input power	9~30 VDC voltage power input at 3-pin terminal block
Power consumption(Typ.)	3 Watts
Overload current protection	Present
Reverse polarity protection	Present on terminal block
<b>Physical Characteristic</b>	
Enclosure	IP-30
Dimension (W x D x H)	88(W) x 102(D) x 24(H)mm (3.46 x 4.0 x 0.94 inch.)
Weight (g)	305 g
<b>Environmental</b>	
Storage Temperature	-40 to 85°C (-40 to 185°F)
Operating Temperature	-10 to 60°C (14 to 140°F)
Operating Humidity	5% to 95% Non-condensing
<b>Regulatory Approvals</b>	
EMI	FCC Part 15, CISPR (EN55022) class A
EMS	EN61000-4-2 (ESD), EN61000-4-3 (RS), EN61000-4-4 (EFT), EN61000-4-5 (Surge), EN61000-4-6 (CS), EN61000-4-8, EN61000-4-11
Shock	IEC60068-2-27
Free Fall	IEC60068-2-32
Vibration	IEC60068-2-6
Safety	EN60950-1
Warranty	5 years

# Quick Installation Guide

## IES-1000 Series

## Industrial Unmanaged Switch

### Installation

#### 8-port / 10-port Switches

##### DIN-Rail Install Step

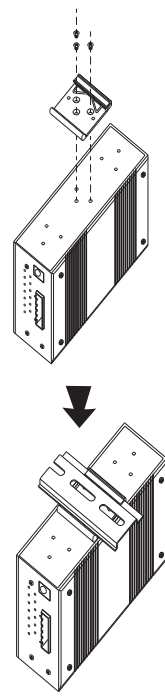

##### Wall-mounted Install Step

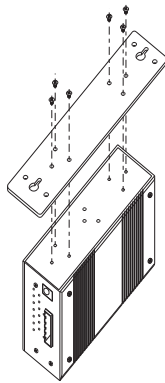

#### 5-port / 6-port / 8-port Switches (Slim type)

##### DIN-Rail Install Step

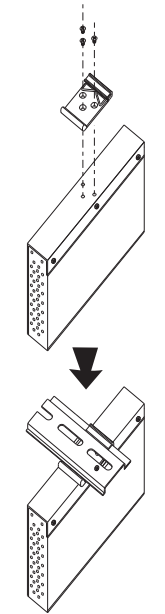

##### Wall-mounted Install Step

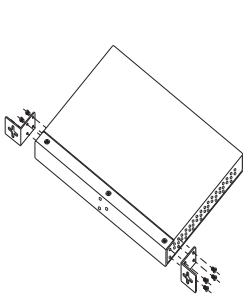

#### 5-port Switches

##### DIN-Rail Install Step

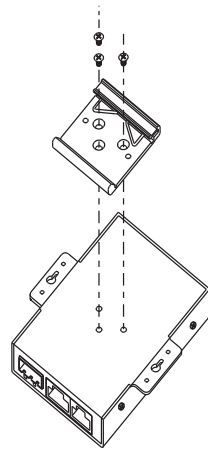

### Accessory

① Wall-mounted kit

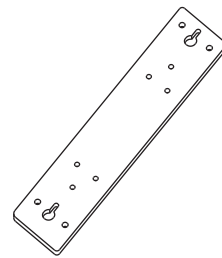

② 45mm DIN-Rail kit

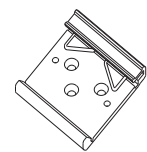

③ Flat Screw (M3 X5)



④ 7-Pin Terminal block

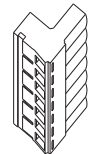

⑤ 3-Pin Terminal block



⑥ 6-Pin Terminal block



⑦ Dust Cover (RJ-45)



⑧ Dust Cover (SFP)

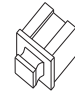

⑨ Round Screw (M3 X3)



⑩ Wall-mounted kit (for Slim Type)



⑪ 25mm DIN-Rail kit

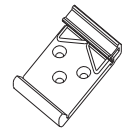

⑫ QIG

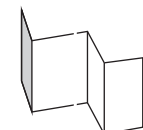

### Front Panel

#### 8-port Switches

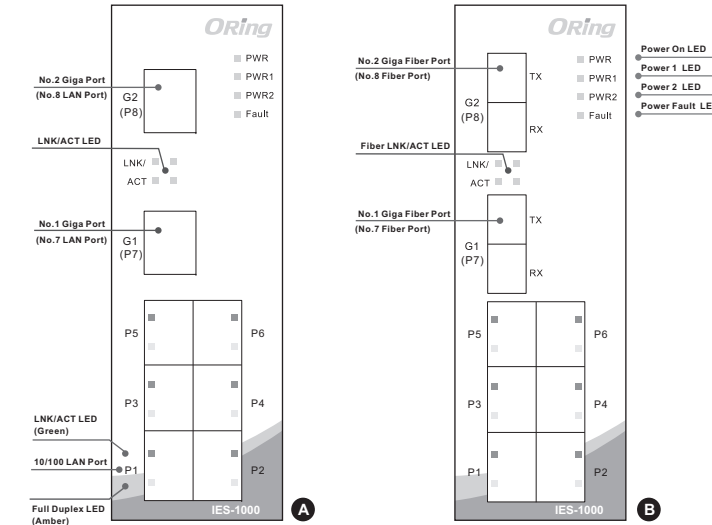

#### 5-port Switches

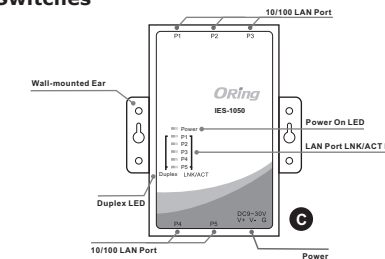

#### 5-port / 6-port / 8-port Switches

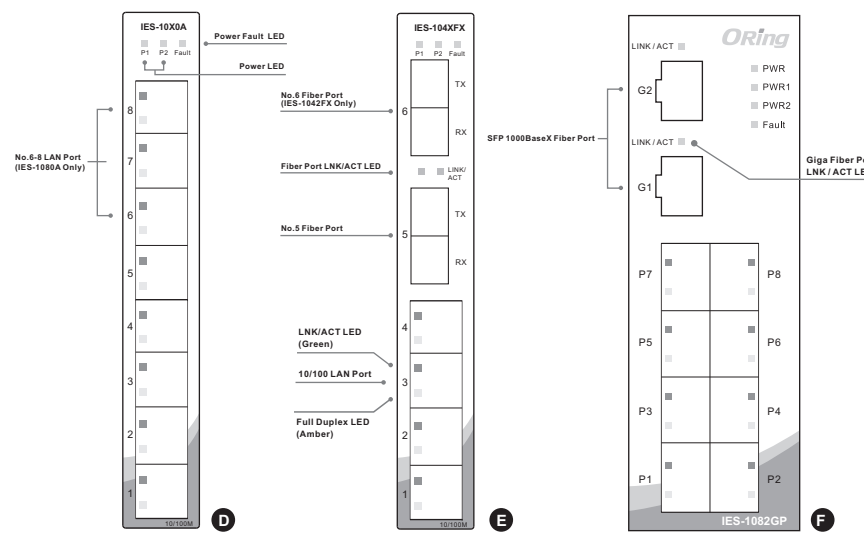

### Packing list

#### IES-1000 Series

Model name	Front Panel	Model Description	Accessory
IES-1080	A	Industrial 8-port unmanaged Ethernet switch with 8x10/100Base-T(X)	⊗X1, ⊗X1, ⊗X6, ⊗X1, ⊗X8, ⊗X1
IES-1062GT	A	Industrial 8-port unmanaged Ethernet switch with 6x10/100Base-T(X) and 2x10/100/1000Base-T(X)	⊗X1, ⊗X1, ⊗X6, ⊗X1, ⊗X8, ⊗X1
IES-1062FX-MM	B	Industrial 8-port unmanaged Ethernet switch with 6x10/100Base-T(X) and 2x100Base-FX, multi-mode	⊗X1, ⊗X1, ⊗X6, ⊗X1, ⊗X8, ⊗X1
IES-1062FX-SS	B	Industrial 8-port unmanaged Ethernet switch with 6x10/100Base-T(X) and 2x1000Base-FX, single-mode	⊗X1, ⊗X1, ⊗X6, ⊗X1, ⊗X8, ⊗X1
IES-1062GF-MM	B	Industrial 8-port unmanaged Ethernet switch with 6x10/100Base-T(X) and 2x1000Base-SX, multi-mode	⊗X1, ⊗X1, ⊗X6, ⊗X1, ⊗X8, ⊗X1
IES-1062GF-SS	B	Industrial 8-port unmanaged Ethernet switch with 6x10/100Base-T(X) and 2x1000Base-LX, single-mode	⊗X1, ⊗X1, ⊗X6, ⊗X1, ⊗X8, ⊗X1
IES-1050	C	Industrial 5-port unmanaged Ethernet switch with 5x10/100Base-T(X)	⊗X1, ⊗X1, ⊗X5, ⊗X1
IES-1082GP	F	Industrial 10-port unmanaged Ethernet switch with 8x10/100Base-T(X) and 2x1000Base-X, SFP socket	⊗X1, ⊗X1, ⊗X6, ⊗X1, ⊗X8, ⊗X2, ⊗X1

#### IES-1000 Series (Slim Type)

Model name	Front Panel	Model Description	Accessory
IES-1050A	D	Industrial 5-port slim type unmanaged Ethernet switch with 5x10/100Base-T(X)	⊗X1, ⊗X5, ⊗X8, ⊗X2, ⊗X1, ⊗X1
IES-1080A	D	Industrial 8-port slim type unmanaged Ethernet switch with 8x10/100Base-T(X)	⊗X1, ⊗X8, ⊗X8, ⊗X2, ⊗X1, ⊗X1
IES-1041FX-MM	E	Industrial 5-port slim type unmanaged Ethernet switch with 4x10/100Base-T(X) and 1x100Base-FX, multi-mode	⊗X1, ⊗X4, ⊗X8, ⊗X2, ⊗X1, ⊗X1
IES-1041FX-SS	E	Industrial 5-port slim type unmanaged Ethernet switch with 4x10/100Base-T(X) and 1x100Base-FX, single-mode	⊗X1, ⊗X4, ⊗X8, ⊗X2, ⊗X1, ⊗X1
IES-1042FX-MM	E	Industrial 6-port slim type unmanaged Ethernet switch with 4x10/100Base-T(X) and 2x100Base-FX, multi-mode	⊗X1, ⊗X4, ⊗X8, ⊗X2, ⊗X1, ⊗X1
IES-1042FX-SS	E	Industrial 6-port slim type unmanaged Ethernet switch with 4x10/100Base-T(X) and 2x100Base-FX, single-mode	⊗X1, ⊗X4, ⊗X8, ⊗X2, ⊗X1, ⊗X1

ORing Industrial Networking Corp.

Copyright© 2008 ORing  
All rights reserved.



TEL: +886-2-2918-3036 Website: www.oring-networking.com  
FAX: +886-2-2918-3084 E-mail: support@oring-networking.com